



[www.trackabout.com.au](http://www.trackabout.com.au)

27 Moss St, Slacks Creek QLD 4127

Email: [sales@trackabout.com.au](mailto:sales@trackabout.com.au) Ph: 07 32081133 Fax: 07 32081170

# 4x4 Deluxe Tourer

## \$12,490.00

### Trailer Specifications

- 7' x 4' Trailer with double pressed Zincaneal panels for added strength
- Powder coated finish on trailer for strength and durability (big choice in colours)
- 520mm high sides
- Duragal heavy duty chassis with 1800x75x50x3mm RHS drawbar
- AL-KO Outback 7 Leaf heavy duty shackle springs with greasable pins
- 10" Solid swing up jockey wheel "U-bolted to drawbar"
- Ozhitch off road coupling 3.5 tonne rating and recessed into drawbar
- Wind down stabilizer legs
- Alloy mudguard trims to prevent stone chips
- Spare wheel mounted on tailgate or drawbar with spare wheel cover
- Mudflaps

### Trailer Features

- 3 x new 15" rims with new 31x10.5 R15 All Terrain tyres (upgrades available)
- 2 x 4.5 kg gas bottle holders
- 2 x Jerry can holders
- 1250l x 355h x 400w top quality lockable alloy toolbox (larger sizes available)
- Tilting bed base on gas struts
- 85 litre water tank with 1 x hand pump tap outside & 1 x hand pump tap in kitchen
- 2 x jerry can holders
- 2 x 100mm PVC pole carriers
- 10" Off road electric brakes (excludes brake controller)
- Drifta DSO kitchen (if this does not suit we have plenty of other kitchen options)
- Heavy duty stone guard
- Bed ladder

### Tent Specifications

- Australian Wax Converters Dynaproofed canvas
- All tents manufactured by Trackabout **(no imported tents)**
- 12oz walls & 15oz roof (see diagram for standard tent sizes)
- 6 large full length windows
- 8' zip on awning with gable front
- 2 x wall vents
- Meshed door with excellent water proof coverage around zips
- Comes standard with kitchen wall
- Quality queen size high density foam mattress
- All pegs, poles and ropes

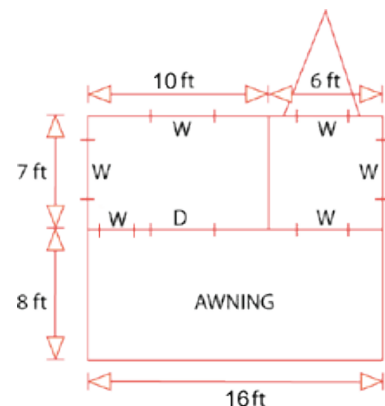

### Legend

D – Door W - Window

See next page for Options